

Broadway Commercial Center
Bellingham, WA



Contact

Hannah Cano
360-676-4866
hannah@saratogacom.com



- 489 - 4,000 sf
- \$9-\$12/sf/yr + NNN
- Close to Downtown
- Ample Parking
- ADA accessible
- Flexible floor plan configurations
- New Building Upgrades

Location:

Located close to downtown Bellingham in the Fountain District. Broadway Commercial Center is less than 2 miles from I-5

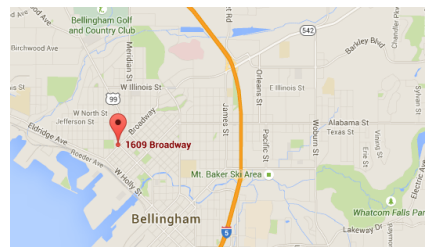

First Floor

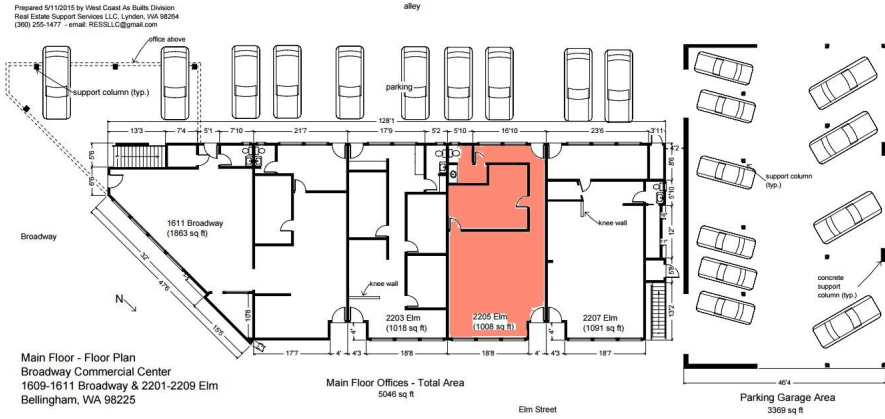

Property Fact Sheet

Address:	2209 Elm & 1609 Broadway
Zoning:	Urban Village
Building:	2-story office building
Parking:	Shared and In Common
Elevator:	Yes

Second Floor



1966 square feet

1021 square feet

1012 square feet

1940 square feet

489 square feet

Contact

Hannah Cano
360-676-4866
hannah@saratogacom.com