

Parkade Building

1306 & 1310 Commercial St,
Bellingham, WA

- 2,107 SF Available
- \$14/SF/YR + NNN +
Leasehold Excise Tax
- Available January 2019
- High Traffic Location in
Downtown Bellingham
- High Ceilings

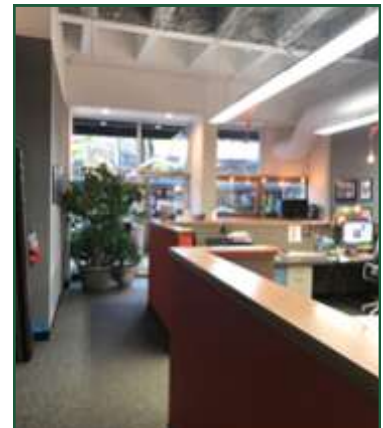

Location



Contact

Hannah Cano
360-676-4866
hannah@saratogacom.com

Parkade Building

PROPERTY FACT SHEET

Address:	1306-1310 Commercial, Bellingham
Building:	Historic Parkade Building
Parking:	Parkade and street parking
Neighboring Tenants:	Jake's Barbershop, Wandering Oaks, Quinn & Foster, Vinostrology, Social Fabric, Bellingham Railway Museum

Commercial Street

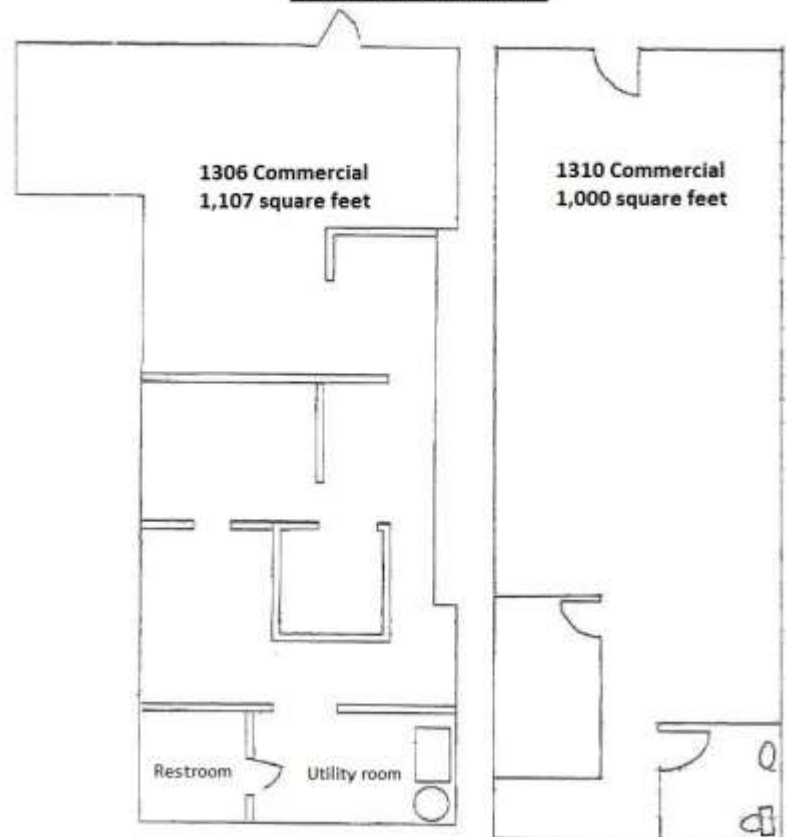

Contact

Hannah Cano
360-676-4866
hannah@saratogacom.com