

INDUSTRIAL/OFFICE LEASE

SARATOGA

HASKELL BUSINESS CENTER WAREHOUSE FOR LEASE

1750 MOORE STREET, BELLINGHAM, WA 98229

\$0.67/SF/MO + NNN

14,682 SF NEWLY RENOVATED WAREHOUSE

- 1,250 SF OFFICE
- 13,432 SF WAREHOUSE
- ADJACENT TO I-5
- AMPLE PARKING
- 2 GRADE LEVEL ROLL UP DOORS + LOADING WELL
- 0.74 ACRES
- ZONING: INDUSTRIAL
- BUILDING: METAL
- DOORS: 2 GRADE LEVEL
- CEILING HEIGHTS: 22' PEAKS, 15' EAVES
- SPRINKLER SYSTEM: NO

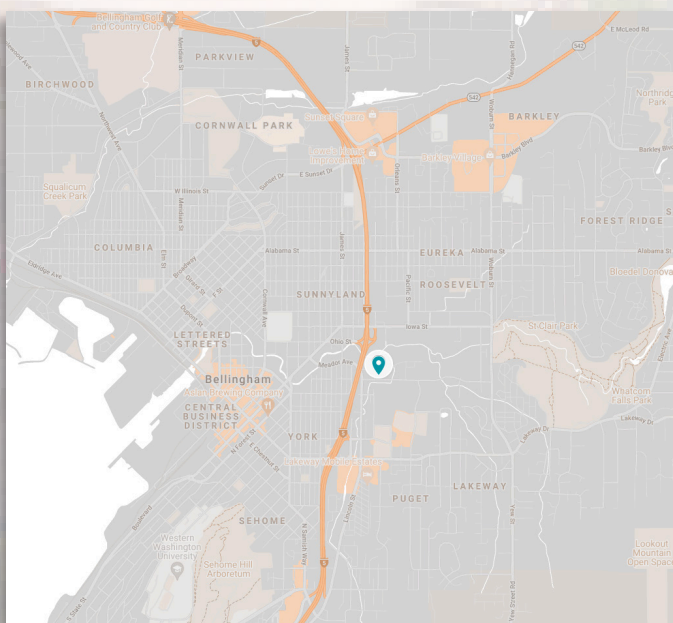

Hannah Cano
hannah@saratogacom.com
360.610.4335

Amia Fraese
amia@saratogacom.com
360.610.7331

www.saratogacom.com
228 E CHAMPION, STE 102, BELLINGHAM, WA 98225

INFORMATION CONTAINED HEREIN HAS BEEN OBTAINED FROM SOURCES DEEMED RELIABLE, BUT NOT GUARANTEED. LESSEE TO VERIFY.

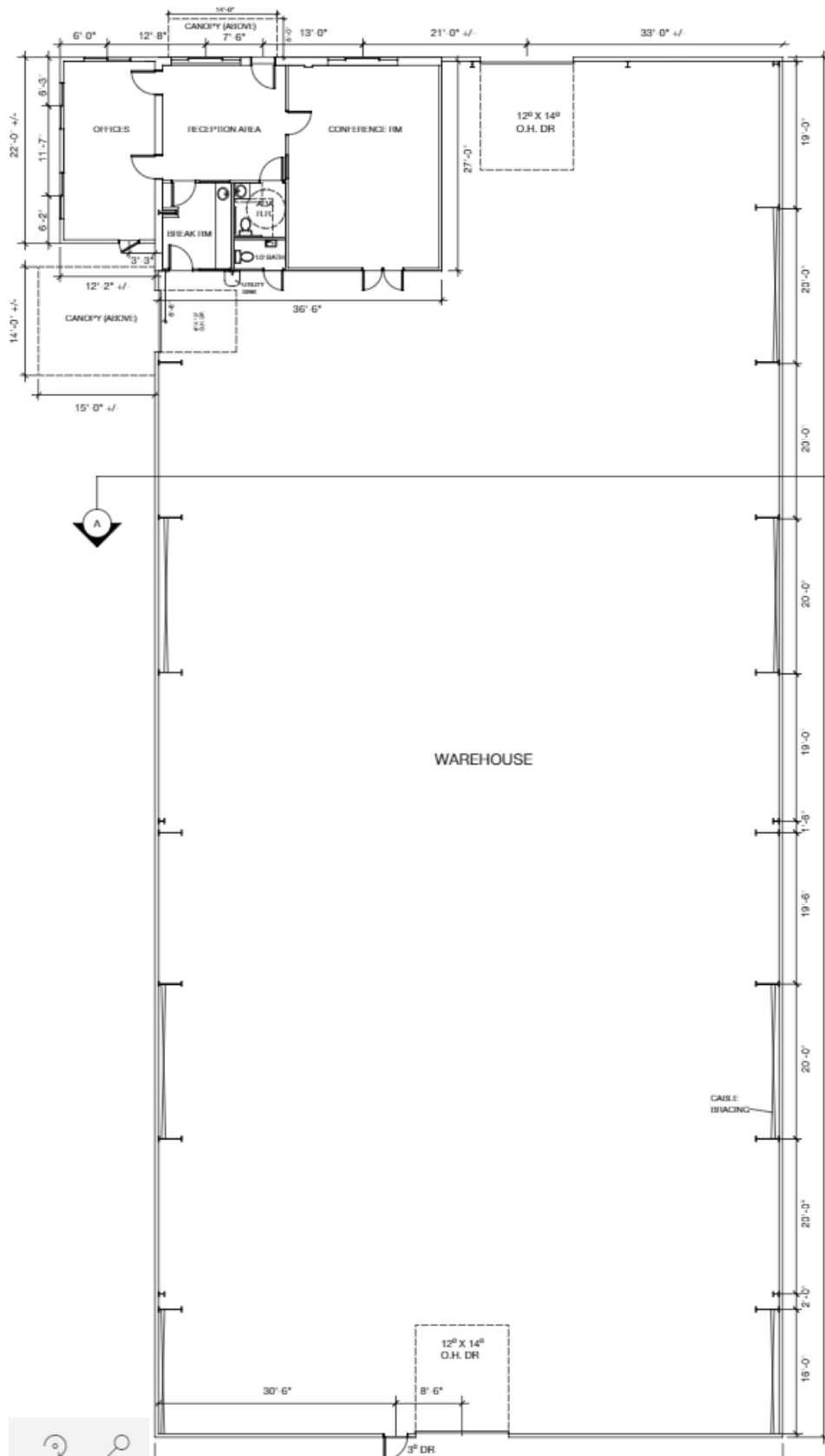



1750 MOORE ST., BELLINGHAM, WA 98229
INDUSTRIAL / OFFICE LEASE

